

FORM NO 1.

Courses of Creek

S 53 W 19
 S 36 W 140
 S 28 W 14
 Down 173 Creek Per

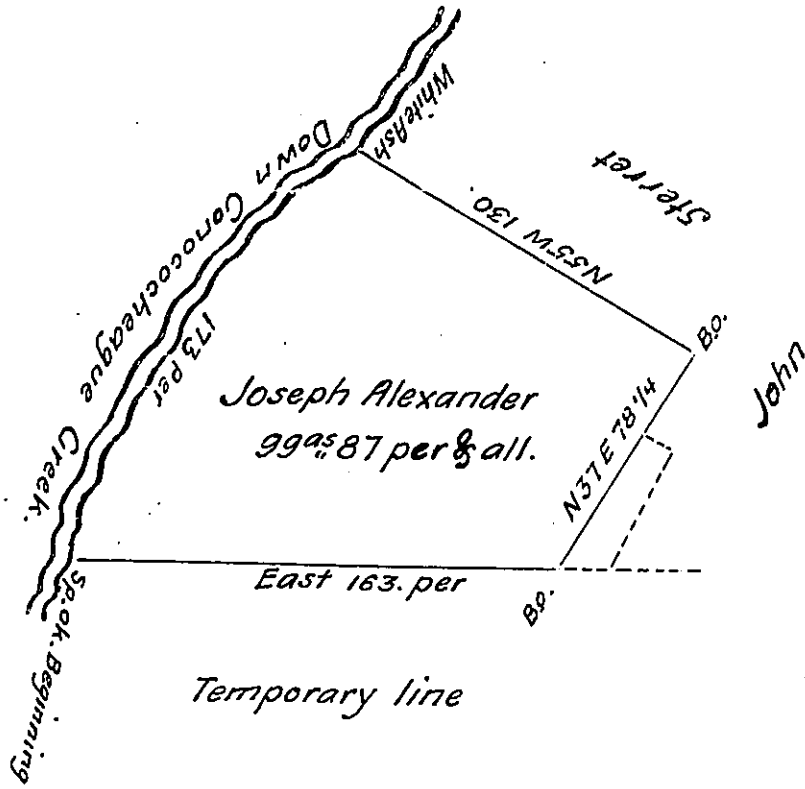

Draft of a Tract of Land Situate in Antrim township Franklin County Con-
 taining Ninety Nine Acres Eighty Seven perches & allowance of Six per Cent for Roads
 &c Which Surveyed by Thomas Cookson Esq. formerly D.S. on a Warrant Granted
 Joseph Alexander for 100^{as} of lands on the Temporary line where it crosses Conococheague
 Joining a place where Matthew Erwin presumed to settle dated the 8th of Feb'y. 1742 Certi-
 fied the 27th of January 1830 In pursuance of a Contract with the Board of property for
 carrying into effect the several Acts of Assembly relating to proprietary rights &c.

To Jacob Spangler Esq. Sur. Genl.

William Hamilton }
 W^m S. Davis. ~ } Contractors

The land above described is included in a Survey containing 113^{as} 98 per & all. which was
 made in pursuance of a Warrant Granted to Robert, Samuel Martin dated the 29th of April
 1799 under which the present owners claim

Abraham Huffert owner & occupier Antrim township

R. & S. Martin Patd.

IN TESTIMONY that the above is a copy of the original remaining on file in
 the Department of Internal Affairs of Pennsylvania, made
 conformably to an Act of Assembly approved the 16th day of
 February, 1833, I have hereunto set my Hand and caused
 the Seal of said Department to be affixed at Harrisburg,
 this thirtieth day of November 1908

Secretary of Internal Affairs.